

EYRUS RFID HAND SCANNER

Quick Start Guide

A quick guide to setting up your Eyrus Visibility app with a hand scanner.

Login to the Eyrus Visibility App and select your project and zone (the area where you are checking people in).

Confirm you have selected the right zone every time you use the scanner.

You can change your zone in settings or by tapping the zone name in blue.

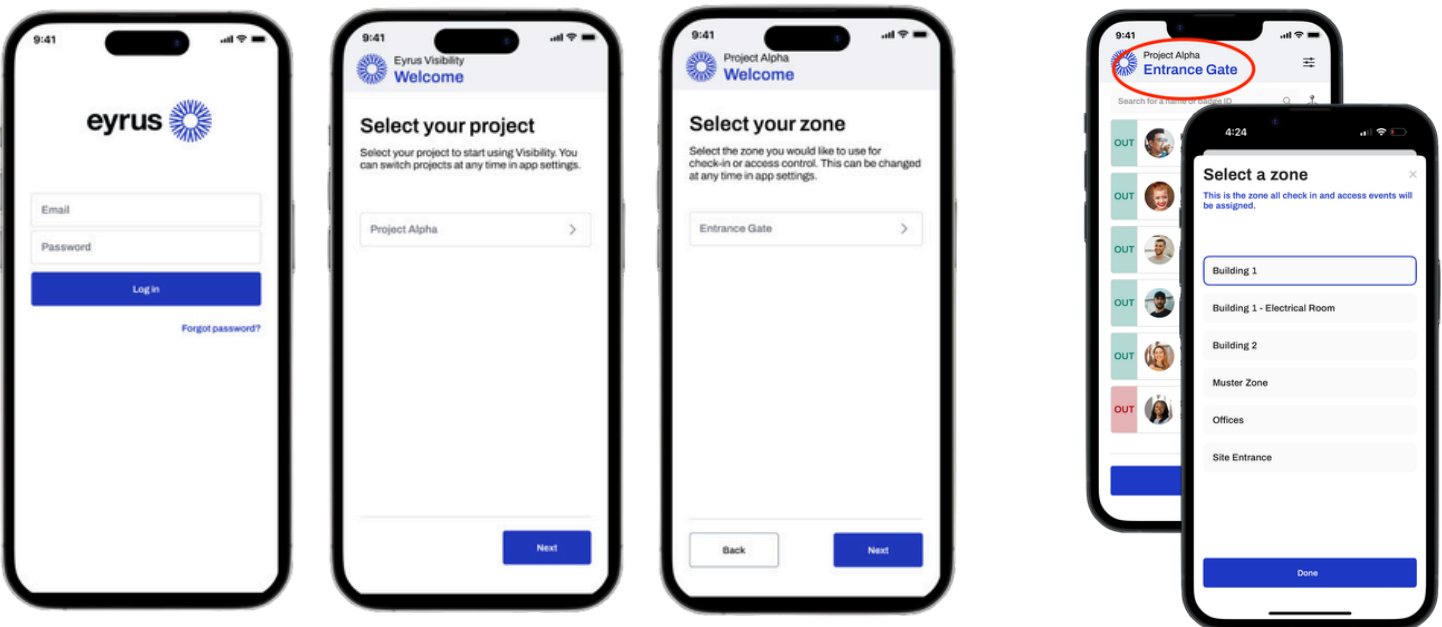

Select Access Control Mode

- Select "Sort by access"
- Choose to set a direction (everyone is scanned in or out). You can leave this unchecked and choose in/out each time you scan.
- If setting a direction, select automatically check in/out.
- We recommend setting Timeout to "1 Minute"
- If using only NFC badges on your site, we recommend going to settings, and selecting "NFC Only"

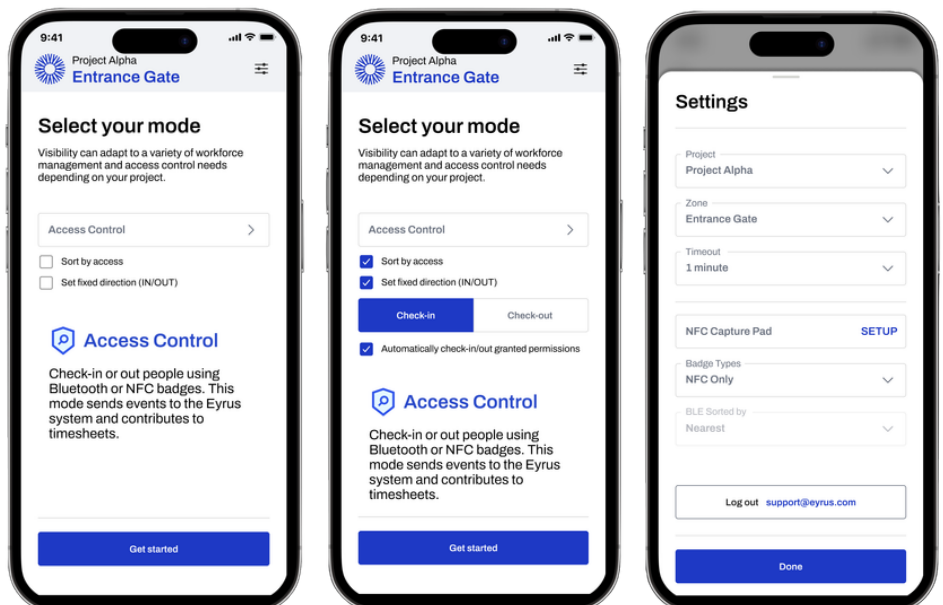

Tap “get started” and you’ll be ready to scan.

1. Pull trigger to scan for worker badges

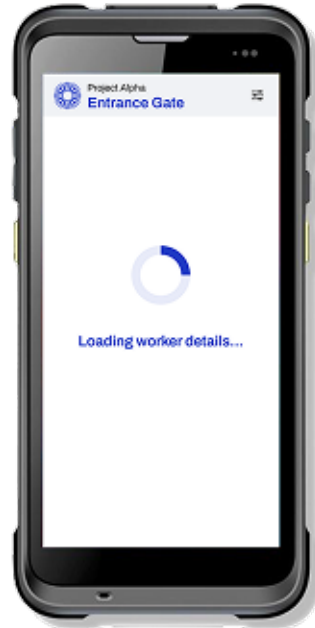

2. Worker Details and Zone Permissions appear
- a. Tap Eye icon to include/exclude from check-in/check-out
 - b. Click “Check-in” or “Check-out”

Group check in, check out, and muster validation during an evacuation are all available actions using this device.

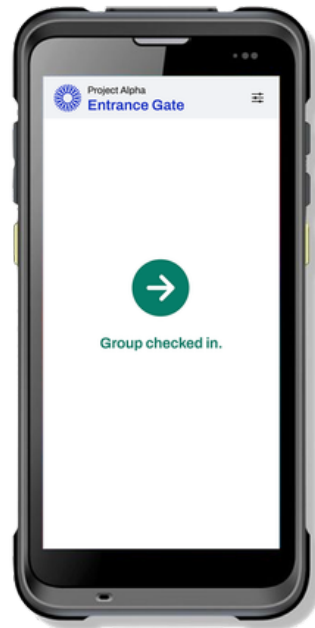
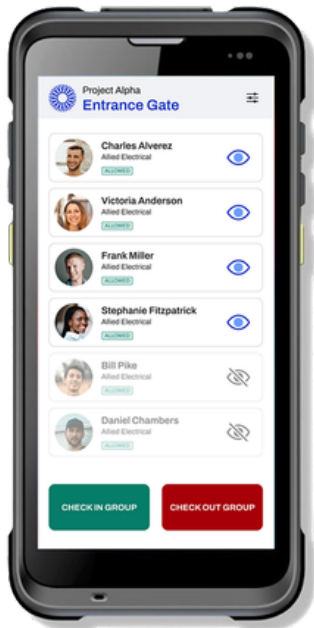

Please note Eyrus RFID/NFC combo badges are required for these scanners.